



STERLING
COMMERCIAL HYDRONIC PRODUCTS



A MESTEK COMPANY



Electric Products



SCEP-2

ELECTRIC PRODUCTS

MODEL SB STANDARD

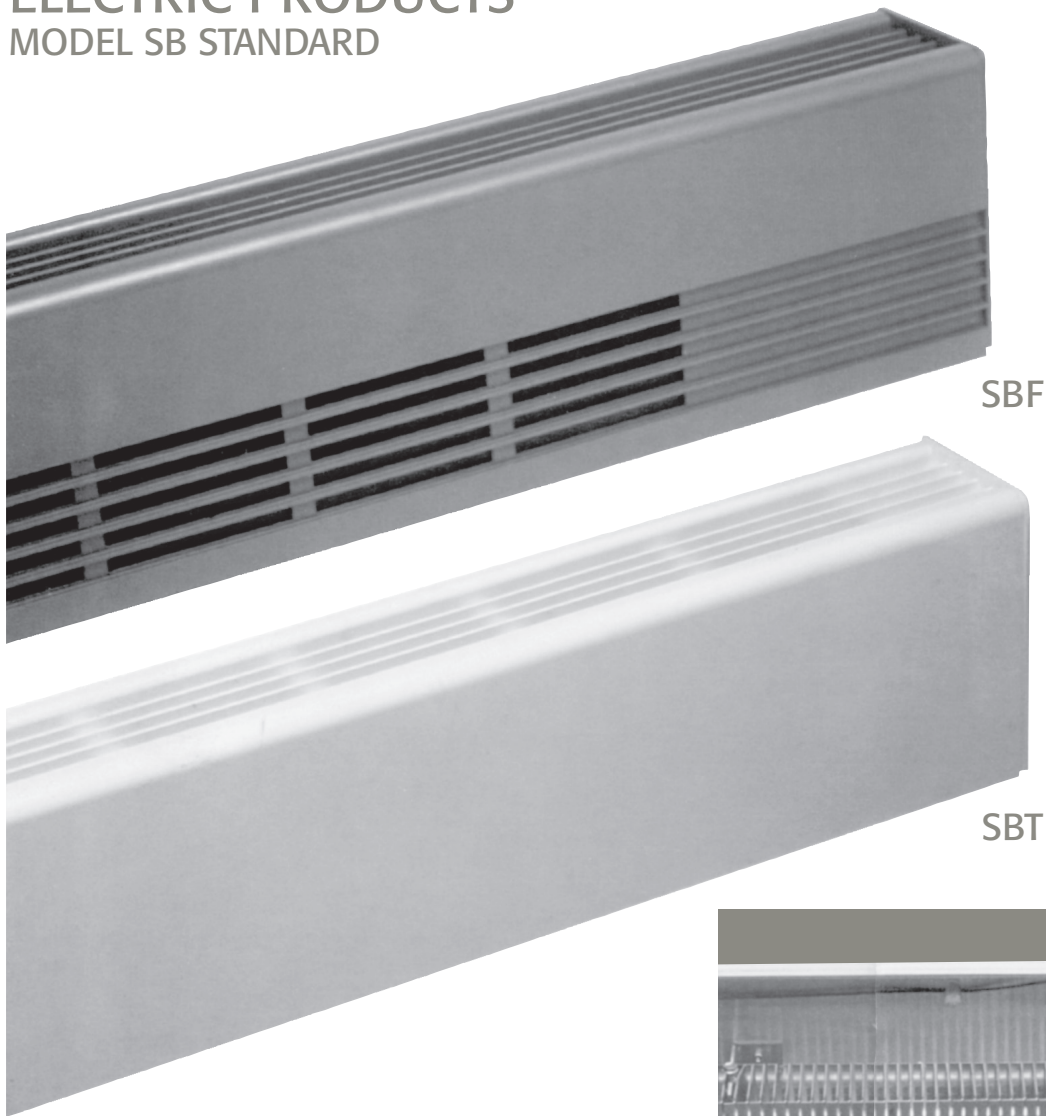

SBF

SBT

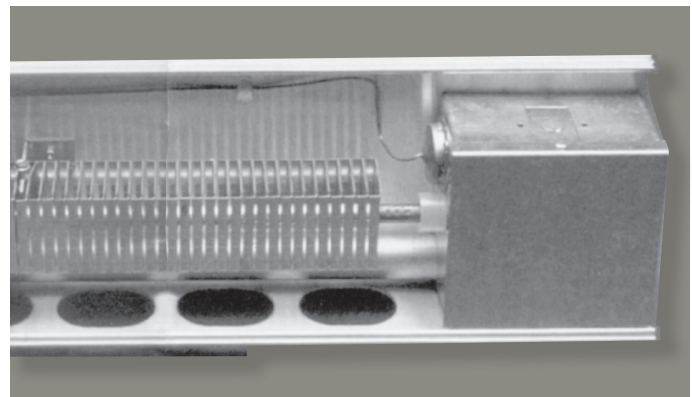

SB FEATURES

SBST - Bottom intake, slope discharge

SBSTF - Front intake, slope discharge

SBT - Bottom intake, top discharge

SBF - Front intake, top discharge

Two piece all aluminum, 14 gauge front and back.

Extended backs and fronts available.

- 4" junction boxes at each end.
- 3/4" EMT raceway standard.
- 1/2" and 3/4" knockouts.
- Control packages available.
- Multiple heater sections on one common back.
- C/UL Listed.
- Full length thermal limit switch.
- There are 8 painted finishes available.

- Custom finishes specified by the architect are available.
 - Available with optional 2" pedestals and finished back.
 - 1/4" pencil proof discharge grill.
 - Accessories include: end caps, walltrims, splice plates, corners and blank sections.
 - Cabinet size is 3"W x 5"H. (3"W x 6"H SBST/F)
 - Available with built in thermostat or disconnect.
 - Wattages from 100 to 250 watts per foot.
- Control sections include 6" or 12" with:
disconnect, thermostat, pneumatic relay, transformer relay,
power relay, fused disconnect or duplex receptacle. Optional
built-in controls shall include thermostats (single and double
pole) and disconnect switches.

SBF-PD

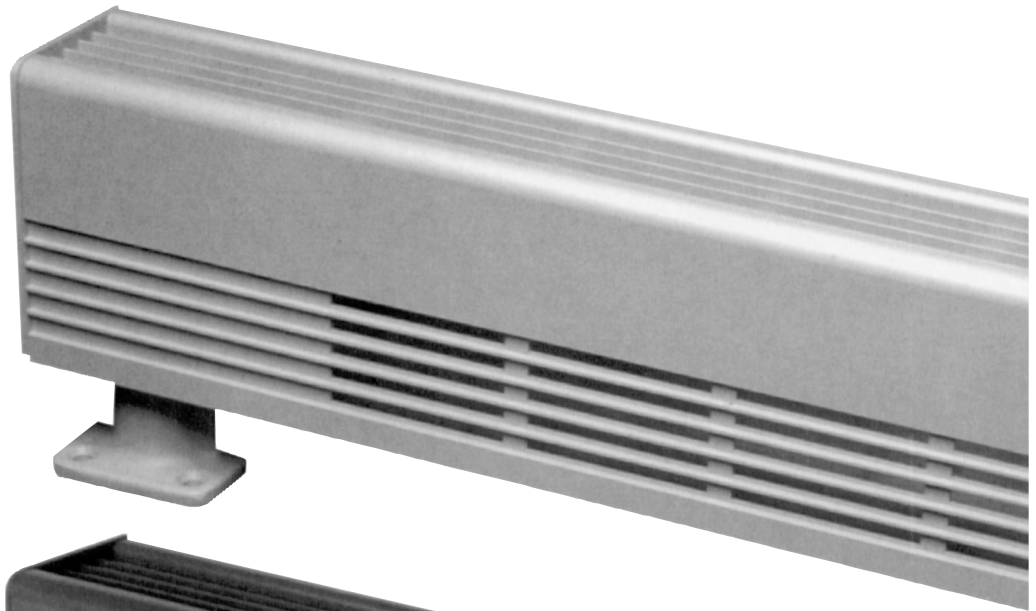

SBT-PD

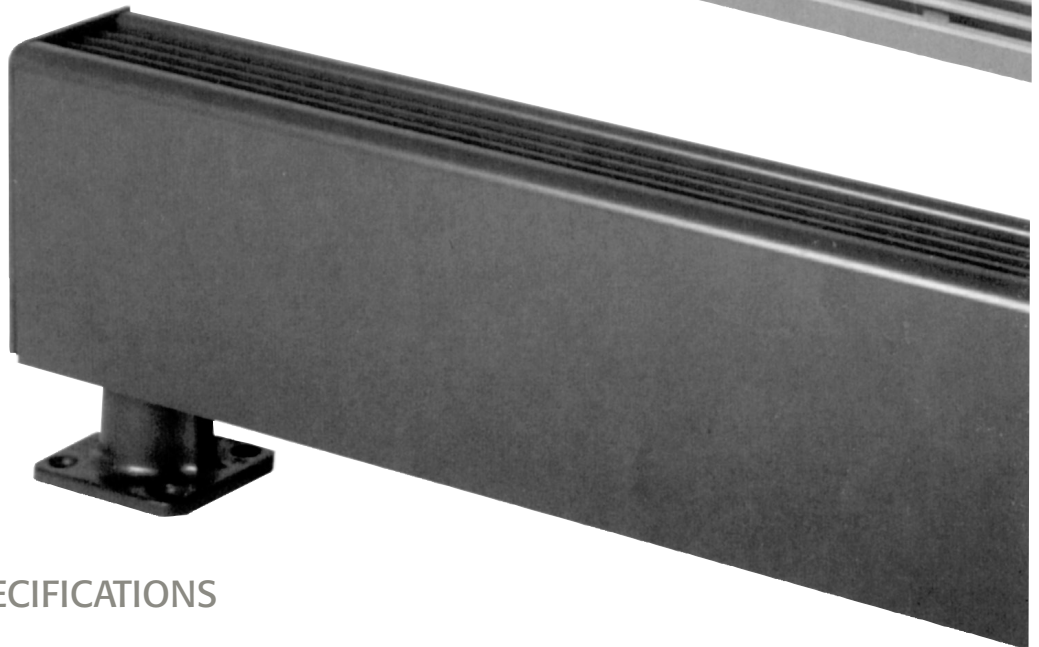

SB ENGINEERING SPECIFICATIONS

Design Draft Barriers shall be 5" high and 3" wide. The front cover shall be one piece 14 gauge aluminum construction suitable for architectural, Commercial and industrial use, with 1/4" pencil proof top discharge.

The one piece cover shall be extruded aluminum for maximum strength and shall be available in lengths to 15'. The front cover shall snap fit to the 14 gauge back cover with no screw heads or assembly fasteners. The 14 gauge back cover shall be suitable for mullion to mullion mounting.

Standard painted finish shall be provided.

Heat sections from 2' through 10' shall be available. All heaters shall contain a 3/4" EMT built-in raceway with factory wiring 1/2" and 3/4" knockouts shall be provided on the side and rear of the heater junction box to allow end to end wiring. All blank sections shall be fully enclosed to allow branch circuit wiring. All heaters shall contain a full length linear thermal overheat protector with automatic reset. Wattages shall be available from 100 to 250 WPF.

Heating elements shall consist of a steel sheath and mechanically bonded aluminum fins to assure efficient heat transfer. Element fin temperature shall not exceed 350°F to ensure long element life. Element shall be center anchored and free floating at each end on nylon bushings.

Optional controls shall include:

Thermostats (single or double pole) and disconnect switches. Controls shall be tamper-proof and adjustable with a blade screwdriver through the discharge grill.

Optional control sections – see page 6.

Accessories – see page 6.

All heaters are labeled by Underwriters' Laboratories, Inc.

ELECTRIC PRODUCTS

MODEL LB STANDARD

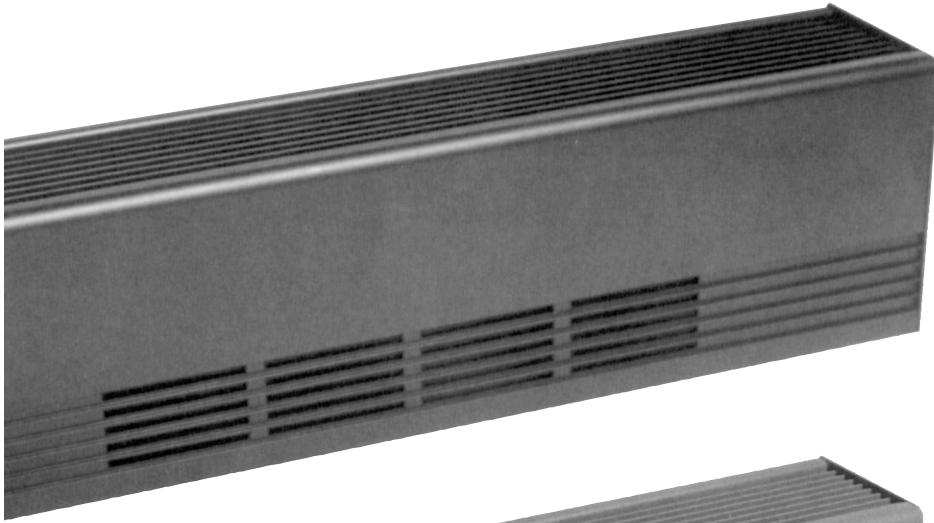

LBF

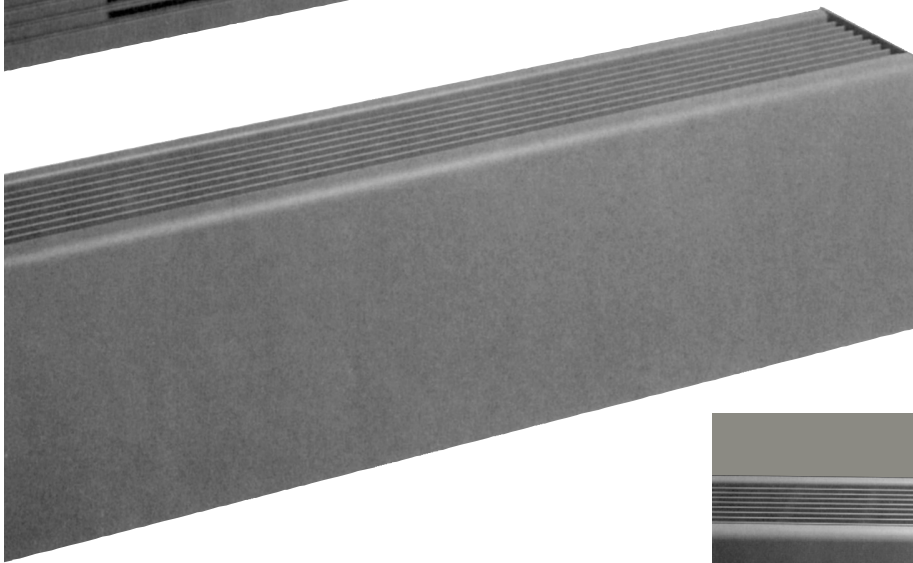

LBT

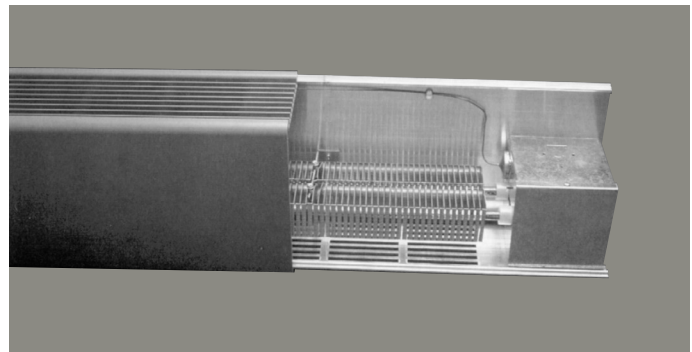

LB FEATURES

LBT - Bottom intake, top discharge

LBF - Front intake, top discharge

Two piece all aluminum, 12 gauge front and back.

- Extended backs and fronts available.
- 4" junction boxes at each end.
- 3/4" EMT raceway standard.
- 1/2" and 3/4" knockouts.
- Control packages available.
- Multiple heater sections on one common back.
- C/UL Listed.
- Full length thermal limit switch.
- There are 8 painted finishes available.
- Custom finishes specified by the architect are available.

- Available with optional 2" pedestals and finished back.
- 1/4" pencil proof discharge grill.
- Accessories include: end caps, walltrims, splice plates, corners and blank sections.
- Cabinet size is 5"W x 7"H.
- Available with built in thermostat or disconnect.
- Wattages from 100 to 500 watts per foot.
Control sections include 6" or 12" with:
disconnect, thermostat, pneumatic relay, transformer relay, relay, fused disconnect or duplex receptacle. Optional built-in controls shall include thermostats (single and double pole) and disconnect switches.

LBF-PD



LBT-PD

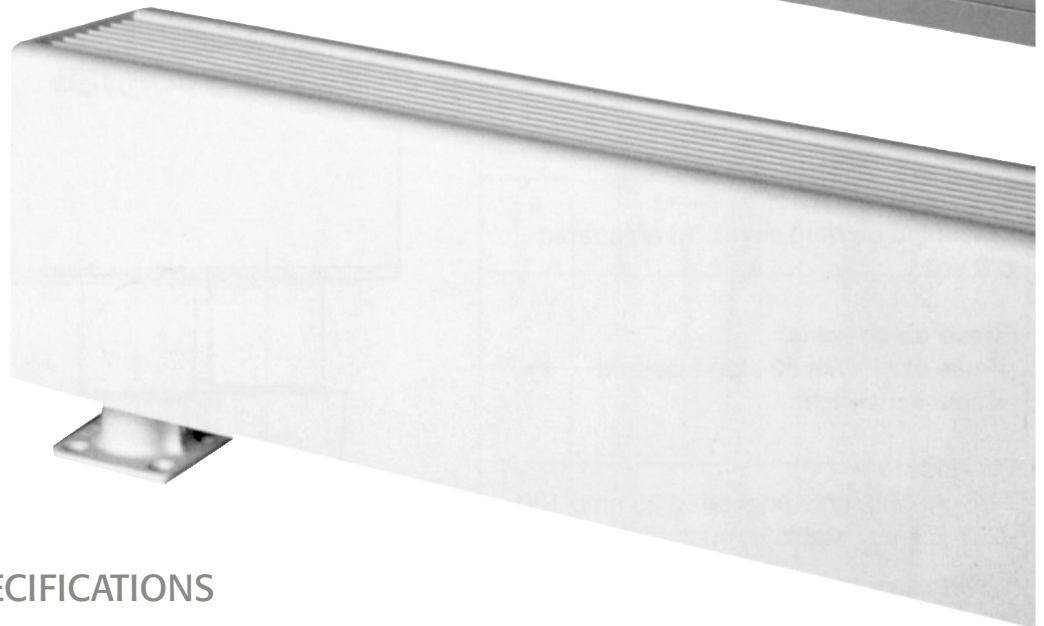

LB ENGINEERING SPECIFICATIONS

Design Draft Barriers shall be 7" high and 5" wide. The front cover shall be one piece 12 gauge aluminum construction suitable for architectural, Commercial and industrial use, with 1/4" pencil proof top discharge.

The one piece cover shall be extruded aluminum for maximum strength and shall be available in lengths to 12'. The front cover shall snap fit to the 12 gauge back cover with no screw heads or assembly fasteners. The 12 gauge back cover shall be suitable for mullion to mullion mounting.

Standard painted finish shall be provided.

Heat sections from 2' through 10' shall be available. All heaters shall contain a 3/4" EMT built-in raceway with factory wiring 1/2" and 3/4" knockouts shall be provided on the side and rear of the heater junction box to allow end to end wiring. All blank sections shall be fully enclosed to allow branch circuit wiring. All heaters shall contain a full length linear thermal overheat protector with automatic reset. Wattages shall be available from 100 to 500 WPF.

Heating elements shall consist of a steel sheath and mechanically bonded aluminum fins to assure efficient heat transfer. Element fin temperature shall not exceed 350°F to ensure long element life. Element shall be center anchored and free floating at each end on nylon bushings.

Optional controls shall include:

Thermostats (single or double pole) and disconnect switches. Controls shall be tamper-proof and adjustable with a blade screwdriver through the discharge grill.

Optional control sections – see page 7.

Accessories – see page 7.

All heaters are labeled by Underwriters' Laboratories, Inc.

SB ACCESSORIES

DUE TO THE SIZE OF THE CABINET, CONTROLS OTHER THAN THERMOSTATS AND DISCONNECTS MUST BE MOUNTED IN A CONTROL SECTION. SEE BELOW.

CONTROL SECTIONS:

12" Control Sections:

12" long and can be attached to the enclosure. Contains 1, 2, or 3 items. right or left side mounting. (6" CS for 1 or 2 items).

TRANSFORMER RELAY:

Single pole, rated 25 amp 120 - 277 volt. Contact rated up to 277 volt (specify). Coils are 24 to 277 volt (specify).

POWER RELAY, CONTACTORS, PE RELAYS, MERCURY RELAY:

Single or double pole (specify). 20 amp rated 120 - 277 volt. Low or line volts coils (specify).

DUPLEX RECEPTACLE:

Mounted on front cover. 15 amp rated 120 volt.

FUSED DISCONNECT:

Fuse block with 20 amp fuse and disconnect switch.

THERMOSTATS:

Single or double pole rated 25 amp 120 - 277 volt adjustable through discharge grill.

DISCONNECT SWITCH:

Double pole rated 20 amp 120 - 277 volt.

ACCESSORIES

| * CAT NO. | DESCRIPTION |
|-----------|-----------------------------------------|
| SB-WT | Wall Trim (specify 4" or 6") |
| SB-SP | Splice Plate |
| SB-EC | End Cap (specify right or left) |
| SB-IC | Inside Corner (specify miter degree) |
| SB-OC | Outside Corner (specify miter degree) |
| SB-BS | Blank Section (specify length 6" - 15') |
| SBT | Bottom Intake, Top Discharge |
| SBF | Front Intake, Top Discharge |

| CATALOG NUMBER | WATTAGE | | BTU/HR | LENGTH |
|----------------|---------|-------|--------|--------|
| | NOMINAL | TOTAL | | |
| SB-2150 | 150 | 300 | 1023 | 2' |
| SB-2200 | 200 | 400 | 1364 | |
| SB-2250 | 250 | 500 | 1706 | |
| SB-3100 | 100 | 300 | 1032 | 3' |
| SB-3125 | 125 | 375 | 1280 | |
| SB-3150 | 150 | 450 | 1535 | |
| SB-3200 | 200 | 600 | 2406 | 4' |
| SB-3250 | 250 | 750 | 2560 | |
| SB-4100 | 100 | 400 | 1364 | |
| SB-4125 | 125 | 500 | 1706 | 5' |
| SB-4150 | 150 | 600 | 2046 | |
| SB-4200 | 200 | 800 | 2728 | |
| SB-4250 | 250 | 1000 | 3414 | 6' |
| SB-5100 | 100 | 500 | 1706 | |
| SB-5125 | 125 | 625 | 2130 | |
| SB-5150 | 150 | 750 | 2560 | 7' |
| SB-5200 | 200 | 1000 | 3414 | |
| SB-5250 | 250 | 1250 | 4266 | |
| SB-6100 | 100 | 600 | 2046 | 8' |
| SB-6125 | 125 | 750 | 2560 | |
| SB-6150 | 150 | 900 | 3069 | |
| SB-6200 | 200 | 1200 | 4092 | 9' |
| SB-6250 | 250 | 1500 | 5120 | |
| SB-7100 | 100 | 700 | 2387 | |
| SB-7125 | 125 | 875 | 2986 | 10' |
| SB-7150 | 150 | 1050 | 3581 | |
| SB-7200 | 200 | 1400 | 4774 | |
| SB-7250 | 250 | 1750 | 5973 | 10' |
| SB-8100 | 100 | 800 | 2728 | |
| SB-8125 | 125 | 1000 | 3413 | |
| SB-8150 | 150 | 1200 | 4092 | 10' |
| SB-8200 | 200 | 1600 | 5456 | |
| SB-8250 | 250 | 2000 | 6826 | |
| SB-9100 | 100 | 900 | 3071 | 10' |
| SB-9125 | 125 | 1125 | 3840 | |
| SB-9150 | 150 | 1350 | 4606 | |
| SB-9200 | 200 | 1800 | 6141 | 10' |
| SB-9250 | 250 | 2250 | 7678 | |
| SB-10100 | 100 | 1000 | 3413 | |
| SB-10125 | 125 | 1250 | 4266 | 10' |
| SB-10150 | 150 | 1500 | 5120 | |
| SB-10200 | 200 | 2000 | 6826 | |
| SB-10250 | 250 | 2500 | 8532 | |

NOTE: Consult factory for 120 volt applications.

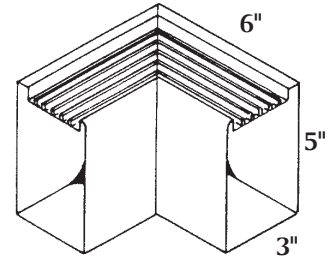

INSIDE CORNER

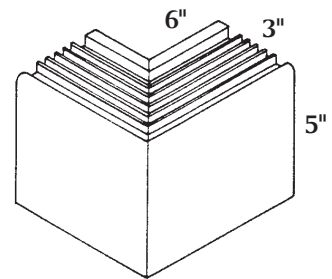

OUTSIDE CORNER

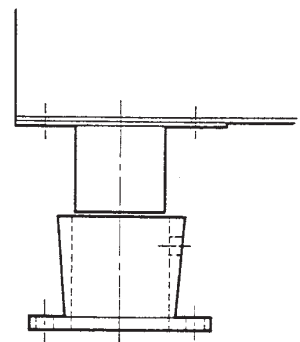

CAST PEDESTAL

ACCESSORIES

| DESCRIPTION | SERIES SBT OR SBF CATALOG NUMBER | DIMENSIONS D/H/L |
|----------------|----------------------------------|------------------|
| BLANKS | SBT or SBF 100BS | 3"x5"x1' |
| | SBT or SBF 200BS | 3"x5"x2' |
| | SBT or SBF 300BS | 3"x5"x3' |
| | SBT or SBF 400BS | 3"x5"x4' |
| | SBT or SBF 500BS | 3"x5"x5' |
| | SBT or SBF 600BS | 3"x5"x6' |
| | SBT or SBF 700BS | 3"x5"x7' |
| | SBT or SBF 800BS | 3"x5"x8' |
| | SBT or SBF 900BS | 3"x5"x9' |
| | SBT or SBF 1000BS | 3"x5"x10' |
| Wall Trim | SBT or SBF - WT | 4" or 6" |
| Splice Plate | SBT or SBF - SP | 2" |
| Inside Corner | SBT or SBF - IC - 90° | |
| Outside Corner | SBT or SBF - OC - 90° | |
| End Caps | SBT or SBF - EC | |

NOTE: Use suffix SBST for Slope Models.

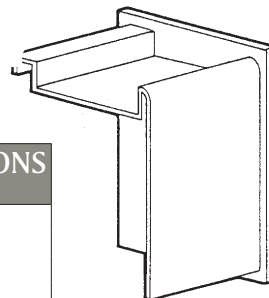

END CAP

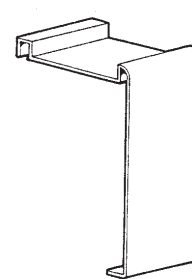

SPLICE PLATE

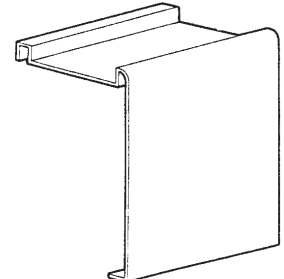

WALL TRIM

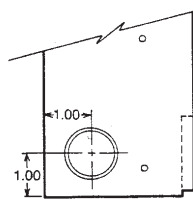

SIDE VIEW

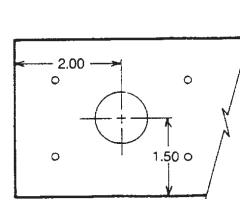

BOTTOM VIEW
Pedestal Unit Only

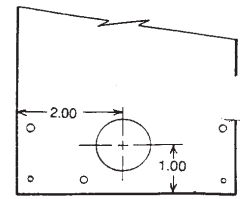

BACK VIEW

LB ACCESSORIES

DUE TO THE SIZE OF THE CABINET,
CONTROLS OTHER THAN THERMOSTATS
AND DISCONNECTS MUST BE MOUNTED IN A
CONTROL SECTION. SEE BELOW.

CONTROL SECTIONS:

12" Control Sections:

12" long and can be attached to the enclosure. Contains 1, 2, or 3 items. right or left side mounting. (6" CS for 1 or 2 items).

TRANSFORMER RELAY:

Single pole, rated 25 amp 120 - 277 volt.
Contact rated up to 277 volt (specify). Coils are 24 to 277 volt (specify).

POWER RELAY, CONTACTORS, PE RELAYS, MERCURY RELAY:

Single or double pole (specify). 20 amp rated 120 - 277 volt. Low or line volts coils (specify).

DUPLEX RECEPTACLE:

Mounted on front cover. 15 amp rated 120 volt.

FUSED DISCONNECT:

Fuse block with 20 amp fuse and disconnect switch.

THERMOSTATS:

Single or double pole rated 25 amp 120 - 277 volt adjustable through discharge grill.

DISCONNECT SWITCH:

Double pole rated 20 amp 120 - 277 volt.

ACCESSORIES

| DESCRIPTION | SERIES LBT OR LBF CATALOG NUMBER | DIMENSIONS D/H/L |
|----------------|----------------------------------|------------------|
| BLANKS | LBT or LBF 100BS | 5"x7"x1' |
| | LBT or LBF 200BS | 5"x7"x2' |
| | LBT or LBF 300BS | 5"x7"x3' |
| | LBT or LBF 400BS | 5"x7"x4' |
| | LBT or LBF 500BS | 5"x7"x5' |
| | LBT or LBF 600BS | 5"x7"x6' |
| | LBT or LBF 700BS | 5"x7"x7' |
| | LBT or LBF 800BS | 5"x7"x8' |
| | LBT or LBF 900BS | 5"x7"x9' |
| | LBT or LBF 1000BS | 5"x7"x10' |
| Wall Trim | LBT or LBF - WT | 4" or 6" |
| Splice Plate | LBT or LBF - SP | 2" |
| Inside Corner | LBT or LBF - IC - 90° | |
| Outside Corner | LBT or LBF - OC - 90° | |
| End Caps | LBT or LBF - EC | |

ACCESSORIES

| * CAT NO. | DESCRIPTION |
|-----------|-----------------------------------------|
| LB-WT | Wall Trim (specify 4" or 6") |
| LB-SP | Splice Plate |
| LB-EC | End Cap (specify right or left) |
| LB-IC | Inside Corner (specify miter degree) |
| LB-OC | Outside Corner (specify miter degree) |
| LB-BS | Blank Section (specify length 6" - 15') |
| LBT | Bottom Intake, Top Discharge |
| LBF | Front Intake, Top Discharge |

| CATALOG NUMBER | WATTAGE | | BTU/HR | LENGTH |
|----------------|---------|-------|--------|--------|
| | NOMINAL | TOTAL | | |
| LB-2150 | 150 | 300 | 1023 | 2' |
| LB-2188 | 188 | 376 | 1275 | 2' |
| LB-2200 | 200 | 400 | 1364 | 2' |
| LB-2250 | 250 | 500 | 1706 | 2' |
| LB-2350 | 350 | 700 | 2387 | 2' |
| LB-2375 | 375 | 750 | 2550 | 2' |
| LB-2500 | 500 | 1000 | 3410 | 2' |
| LB-3100 | 100 | 300 | 1032 | 3' |
| LB-3125 | 125 | 375 | 1280 | 3' |
| LB-3150 | 150 | 450 | 1535 | 3' |
| LB-3188 | 188 | 564 | 1914 | 3' |
| LB-3200 | 200 | 600 | 2406 | 3' |
| LB-3250 | 250 | 750 | 2560 | 3' |
| LB-3350 | 350 | 1050 | 3580 | 3' |
| LB-3375 | 375 | 1125 | 3828 | 3' |
| LB-3500 | 500 | 1500 | 5720 | 3' |
| LB-4100 | 100 | 400 | 1364 | 4' |
| LB-4125 | 125 | 500 | 1706 | 4' |
| LB-4150 | 150 | 600 | 2046 | 4' |
| LB-4188 | 188 | 752 | 2550 | 4' |
| LB-4200 | 200 | 800 | 2728 | 4' |
| LB-4250 | 250 | 1000 | 3414 | 4' |
| LB-4350 | 350 | 1400 | 4774 | 4' |
| LB-4375 | 375 | 1500 | 5100 | 4' |
| LB-4500 | 500 | 2000 | 6826 | 4' |
| LB-5100 | 100 | 500 | 1706 | 5' |
| LB-5125 | 125 | 625 | 2130 | 5' |
| LB-5150 | 150 | 750 | 2560 | 5' |
| LB-5188 | 188 | 940 | 3189 | 5' |
| LB-5200 | 200 | 1000 | 3414 | 5' |
| LB-5250 | 250 | 1250 | 4266 | 5' |
| LB-5350 | 350 | 1750 | 5973 | 5' |
| LB-5375 | 375 | 1875 | 6378 | 5' |
| LB-5500 | 500 | 2500 | 8532 | 5' |
| LB-6100 | 100 | 600 | 2046 | 6' |
| LB-6125 | 125 | 750 | 2560 | 6' |
| LB-6150 | 150 | 900 | 3069 | 6' |
| LB-6188 | 188 | 1128 | 3825 | 6' |
| LB-6200 | 200 | 1200 | 4092 | 6' |
| LB-6250 | 250 | 1500 | 5120 | 6' |
| LB-6350 | 350 | 2100 | 7161 | 6' |
| LB-6375 | 375 | 2250 | 7650 | 6' |
| LB-6500 | 500 | 3000 | 10230 | 6' |
| LB-7100 | 100 | 700 | 2387 | 7' |
| LB-7125 | 125 | 875 | 2966 | 7' |
| LB-7150 | 150 | 1050 | 3581 | 7' |
| LB-7188 | 188 | 1316 | 4464 | 7' |
| LB-7200 | 200 | 1400 | 4774 | 7' |
| LB-7250 | 250 | 1750 | 5973 | 7' |
| LB-7350 | 350 | 2450 | 8354 | 7' |
| LB-7375 | 375 | 2625 | 8928 | 7' |
| LB-7500 | 500 | 3500 | 11935 | 7' |
| LB-8100 | 100 | 800 | 2728 | 8' |
| LB-8125 | 125 | 1000 | 3413 | 8' |
| LB-8150 | 150 | 1200 | 4092 | 8' |
| LB-8188 | 188 | 1504 | 5100 | 8' |
| LB-8200 | 200 | 1600 | 5456 | 8' |
| LB-8250 | 250 | 2000 | 6826 | 8' |
| LB-8350 | 350 | 2800 | 9548 | 8' |
| LB-8375 | 375 | 3000 | 10200 | 8' |
| LB-8500 | 500 | 4000 | 13640 | 8' |
| LB-9100 | 100 | 900 | 3071 | 9' |
| LB-9125 | 125 | 1125 | 3840 | 9' |
| LB-9150 | 150 | 1350 | 4656 | 9' |
| LB-9188 | 188 | 1692 | 5758 | 9' |
| LB-9200 | 200 | 1800 | 6141 | 9' |
| LB-9250 | 250 | 2250 | 7678 | 9' |
| LB-9350 | 350 | 3150 | 10741 | 9' |
| LB-9375 | 375 | 3375 | 11516 | 9' |
| LB-9500 | 500 | 4500 | 15345 | 9' |
| LB-10100 | 100 | 1000 | 3413 | 10' |
| LB-10125 | 125 | 1250 | 4266 | 10' |
| LB-10150 | 150 | 1500 | 5120 | 10' |
| LB-10188 | 188 | 1880 | 6375 | 10' |
| LB-10200 | 200 | 2000 | 6826 | 10' |
| LB-10250 | 250 | 2500 | 8532 | 10' |
| LB-10350 | 350 | 3500 | 11935 | 10' |
| LB-10375 | 375 | 3750 | 12750 | 10' |
| LB-10500 | 500 | 5000 | 17050 | 10' |

NOTE: Consult factory for 120 volt applications.

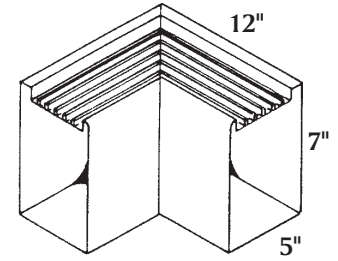

INSIDE CORNER

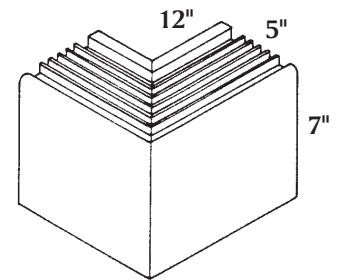

OUTSIDE CORNER

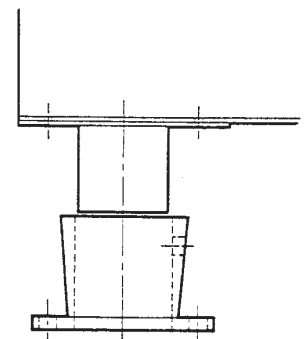

CAST PEDESTAL

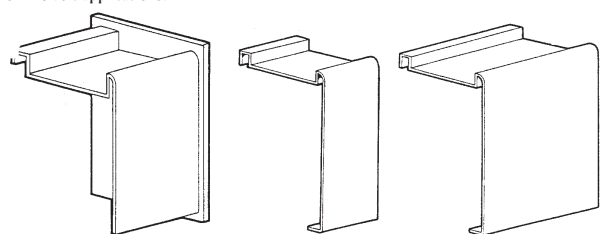

END CAP

SPLICE PLATE

WALL TRIM

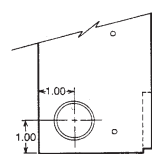

SIDE VIEW

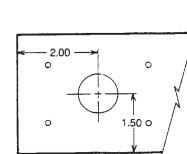

BOTTOM VIEW

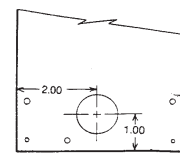

BACK VIEW

Pedestal Unit Only

ELECTRIC PRODUCTS COLOR CHART PAINTED FINISHES

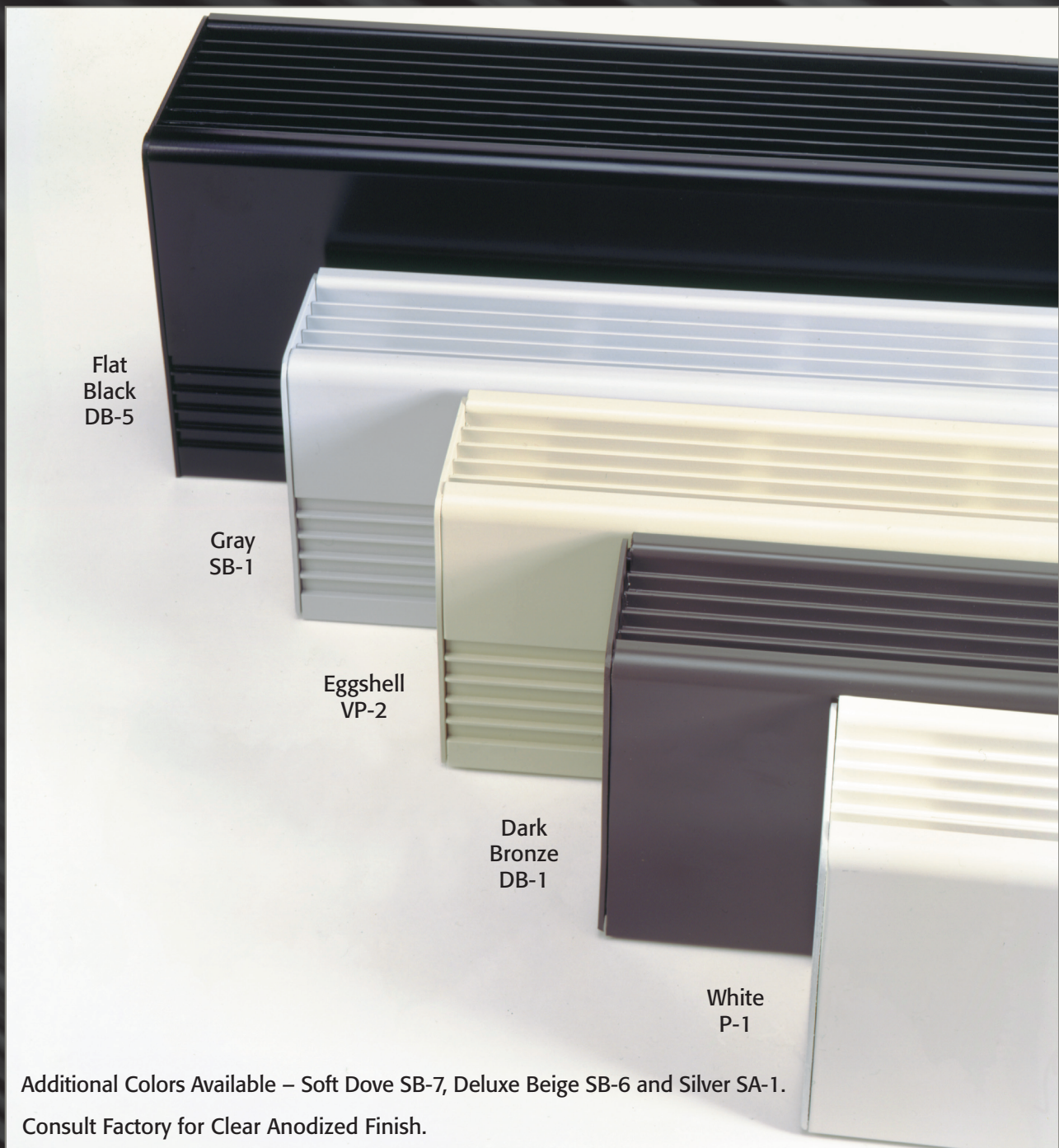

260 North Elm Street, Westfield MA 01085
Tel: (413) 564-5535 FAX: (413) 562-8437
www.sterlingheat.com

 A MESTEK COMPANY